

## RACCORDI DIN

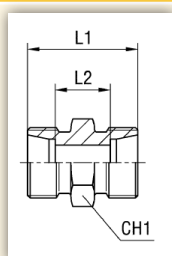

## INTERMEDIO DIN DIRITTO



TIPO: EGC1035...1 SOLO CORPO

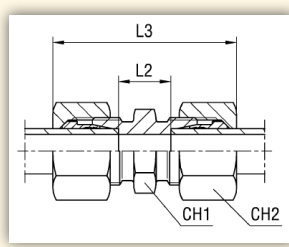

TIPO: EGC1035.. ANELLO B3

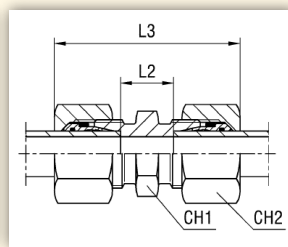

EGC1035...4 ANELLO B4



Serie	Bar	CODICE Solo Corpo	CODICE Completo B3	Ø Tubo	Dimensioni mm					CODICE Completo B4
					L1	L2	L3	CH1	CH2	
LL	100	EGC103501.1	EGC103501	4	20	12	31	12	10	-
		EGC103502.1	EGC103502	6	20	9	32	12	12	-
		EGC103503.1	EGC103503	8	23	12	35	12	14	-
L	315	EGC103504.1	EGC103504	6	24	10	39	12	14	EGC103504.4
		EGC103505.1	EGC103505	8	25	11	40	14	17	EGC103505.4
		EGC103506.1	EGC103506	10	27	13	42	17	19	EGC103506.4
		EGC103507.1	EGC103507	12	28	14	43	19	22	EGC103507.4
		EGC103508.1	EGC103508	15	30	16	46	24	27	EGC103508.4
		EGC103509.1	EGC103509	18	31	16	48	27	32	EGC103509.4
	160	EGC103510.1	EGC103510	22	35	20	52	32	36	EGC103510.4
		EGC103511.1	EGC103511	28	36	21	54	41	41	EGC103511.4
		EGC103512.1	EGC103512	35	41	20	63	46	50	EGC103512.4
		EGC103513.1	EGC103513	42	43	21	66	55	60	EGC103513.4
S	630	EGC103514.1	EGC103514	6	30	16	45	14	17	EGC103514.4
		EGC103515.1	EGC103515	8	32	18	47	17	19	EGC103515.4
		EGC103516.1	EGC103516	10	32	17	49	19	22	EGC103516.4
		EGC103517.1	EGC103517	12	34	19	51	22	24	EGC103517.4
		EGC103518.1	EGC103518	14	38	22	57	24	27	EGC103518.4
	400	EGC103519.1	EGC103519	16	38	21	57	27	30	EGC103519.4
		EGC103520.1	EGC103520	20	44	23	66	32	36	EGC103520.4
		EGC103521.1	EGC103521	25	50	26	74	41	46	EGC103521.4
		EGC103522.1	EGC103522	30	54	27	80	46	50	EGC103522.4
		315	EGC103523.1	EGC103523	38	61	29	90	55	60

I raccordi presenti in questa pagina sono fornibili anche in **ACCIAIO INOX AISI 316**  
Il codice cambia alla quinta cifra come nell'esempio:

EGC	10	03	07
EGC	11	03	07

> codice raccordo standard

> codice stesso raccordo in acciaio inox AISI 316

