

DIRITTO - FEMMINA/FEMMINA - GAS CILINDRICO

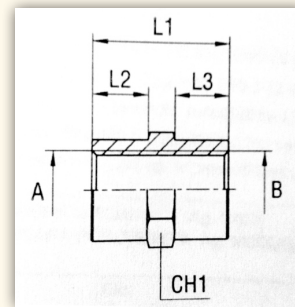

CODICE	Bar	Filettatura A	Filettatura B	Dimensioni mm			
				L1	L2	L3	CH1
EGC301201	350	1/8"	1/8"	20	7	7	14
EGC301202	350	1/4"	1/4"	30	12	12	19
EGC301203	250	3/8"	3/8"	30	12	12	24
EGC301204	225	1/2"	1/2"	38	15	15	27
EGC301205	200	3/4"	3/4"	40	15	15	36
EGC301206	160	1"	1"	48	19	19	41
EGC301207	160	1.1/4"	1.1/4"	50	19	19	55
EGC301208	160	1.1/2"	1.1/2"	50	18	18	60