

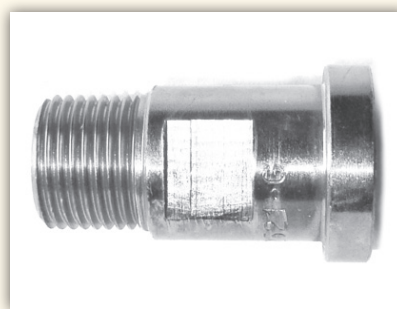

difast

ADATTATORE DIRITTO - FLANGIA SAE / MASCHIO GAS CILINDRICO

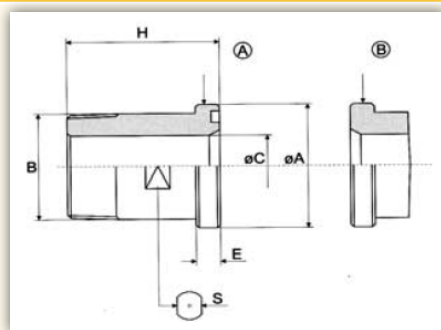

CODICE	Filettatura B	Flangia	A	E	C	H	Chiave S	Pressione max
	BSP	SAE	mm	mm	mm	mm	mm	bar
EF0GDF308	1/2"	3000 1/2"	30,2	6,7	12	50	19	210
EF0GDF312	3/4"	3000 3/4"	38,1	6,7	17	55	27	210
EF0GDF315	3/4"	3000 1"	44,4	8	17	60	32	210
EF0GDF316	1"	3000 1"	44,4	8	22	60	32	210
EF0GDF320	1.1/4"	3000 1.1/4"	50,8	8	27	65	41	210
EF0GDF324	1.1/2"	3000 1.1/2"	60,3	8	32	70	46	210
EF0GDF332	2"	3000 2"	71,4	9,5	40	75	55	210
EF0GDF608	1/2"	6000 1/2"	31,8	7,7	12	50	19	420
EF0GDF612	3/4"	6000 3/4"	41,3	8,7	17	60	26	420
EF0GDF615	3/4"	6000 1"	47,6	9,5	17	70	32	420
EF0GDF616	1"	6000 1"	47,6	9,5	22	70	32	420
EF0GDF619	1"	6000 1.1/4"	54	10,3	22	75	36	420
EF0GDF620	1.1/4"	6000 1.1/4"	54	10,3	27	75	36	420
EF0GDF624	1.1/2"	6000 1.1/2"	63,5	12,5	32	80	46	420