

90° ORIENTABILE - MASCHIO JIC / MASCHIO UNF

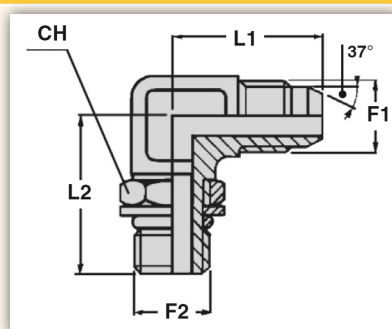

CODICE	Filettatura F1	Filettatura F2 *	Dimensioni mm		
			L1	L2	CH
EF000419N	7/16"-20	7/16"-20	22,5	26	14
EF000420N	1/2"-20	1/2"-20	24	27,5	16
EF000421N	9/16"-18	9/16"-18	27	31,5	17
EF000422N	3/4"-16	3/4"-16	32	36,5	22
EF000423N	7/8"-14	7/8"-14	36,5	43	27
EF000424N	1.1/16"-12	1.1/16"-12	42	49	32
EF000425N	1.5/16"-12	1.5/16"-12	46	52	38
EF000426N	1.5/8"-12	1.5/8"-12	52	57	48

* Maschio UNF sede piana con o-ring e rondella



Filettature da 7/16"-20 a 7/8"-14
in accordo a UNF-2A

Filettature da 1.1/16"-12 a 1.7/8"-12
in accordo a UN-2A